

#8599

Newly built villas in Vera Playa, Almería: modern homes near the sea

€429,000

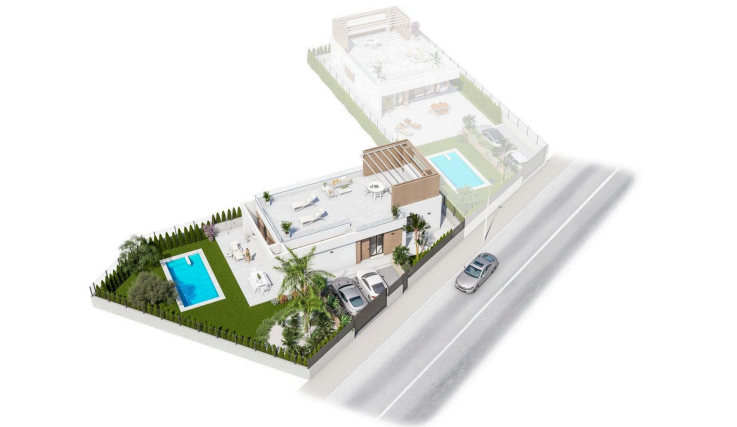



Overview

Specifications

Bedrooms

 3

Bathrooms

 2

Covered

 105 m²

Type

Villa

Plot

344 m²

Status

Key ready

Energy efficiency rating

 **B**

Description

Newly built villas in Vera Playa, Almería: modern homes near the sea

Contemporary living in Pueblo Salinas, just 2 km from the beach

We present an impressive new residential development located in the sought-after area of Vera Playa, within the exclusive Pueblo Salinas urbanisation. This modern complex offers a privileged lifestyle just 2 km from the beaches of Vera (Almería), with spectacular sea views and a peaceful Mediterranean setting ideal for year-round living or enjoying holidays.

Elegant homes with modern comfort and style

This new phase consists of 17 high-quality villas with a choice of 3 or 4 bedrooms and 2 or 3 full bathrooms on one floor for added convenience.

With a private swimming pool with heat pump and parking area on the plot with pre-installation for electric vehicle charging points, offering maximum comfort in an unbeatable location, ideal for enjoying the sun, the beach and the Mediterranean quality of life all year round.

Some of these homes have a basement (providing additional space to suit your needs and lifestyle) and/or a private rooftop solarium with a summer kitchen and pergola area with solar panels.

The villas have elegant and functional interiors, fully equipped kitchens with all appliances, and pre-installation for ducted air conditioning.

All properties feature:

Fully equipped open-plan kitchens with integrated fridge, dishwasher, induction hob, oven, microwave and extractor hood

Bright and airy spaces with LED lighting throughout the property (except in the bedrooms)

Motorised blinds in the bedrooms

Bathrooms with modern finishes, including towel heaters, glass-enclosed shower trays and built-in furniture

Floor plans



VILLA D3.11 HOUSE D3.11

CUADRO DE SUPERFICIES - SIZES
 Sup. Construida - Building m²: 105,00 m²
 Terraza cubierta - Porch: 6,09 m²
 Terraza - Terrace: 208,60 m²
 TOTAL: 319,69 m²

PARCELA D3.11
 344 M2



Additional information

Facilities

Aircondition, Provision Gated complex Parking, Uncovered

Features

Garden Sea view

Distances

Sea
 1.8 km