

#8515

# New Build Bungalows in San Pedro del Pinatar – Luxury and Nature by the Sea

📍 San Pedro del Pinatar, Murcia

€276,000





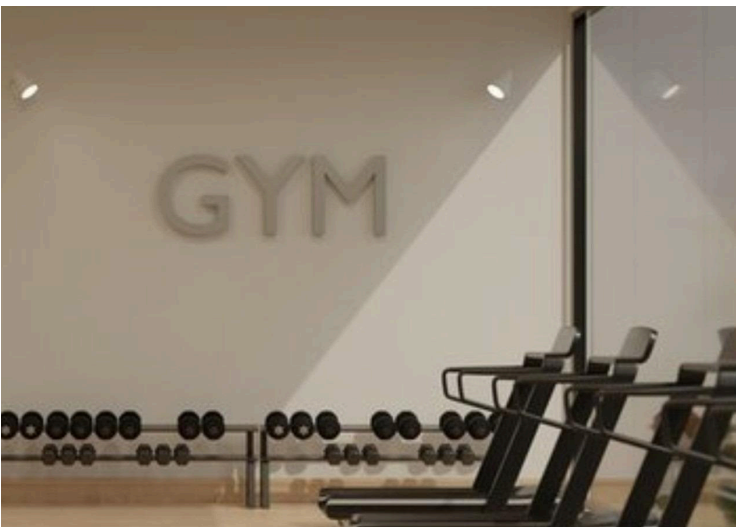
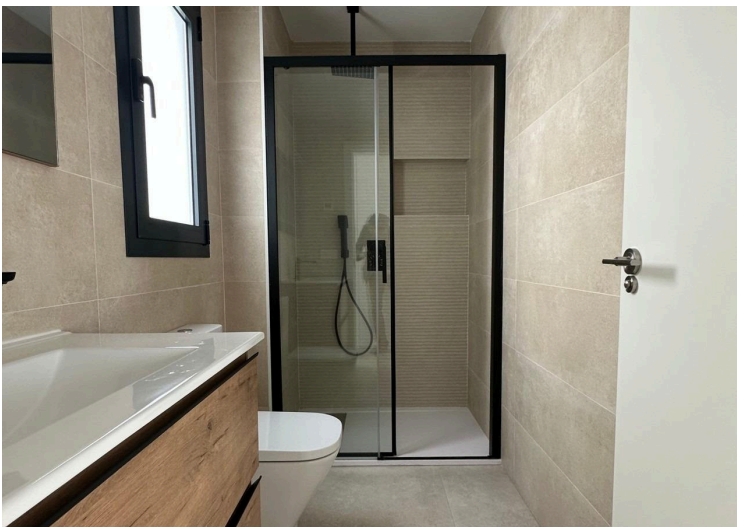
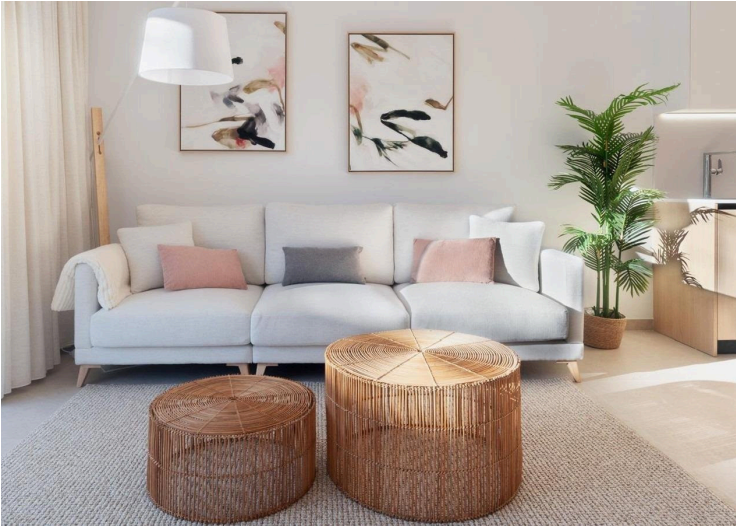
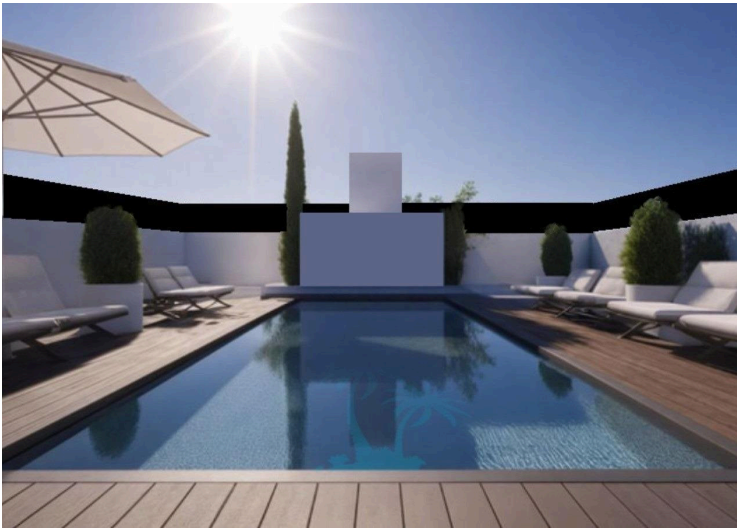





# Overview

## Specifications

Bedrooms		Bathrooms		Covered	
 2		 2		 69 m <sup>2</sup>	
Type		Bungalow		Status	
Plot		16 m <sup>2</sup>		Energy efficiency rating	
				Key ready  B	

## Description

New Build Bungalows in San Pedro del Pinatar – Luxury and Nature by the Sea

### Prime Location Near Beaches and Nature Reserve

Discover an exclusive residential complex of new build bungalows located in one of the most privileged areas of San Pedro del Pinatar, Murcia. Just 1.8 km from the beaches of the Mediterranean Sea and only 500 metres from the protected Salinas y Arenales Regional Park, this development offers a unique lifestyle surrounded by nature, tranquillity and all essential services.

The complex sits in a peaceful residential neighborhood facing a large park, with easy walking access to supermarkets, shops, cafés, the town centre, and the local bus station, providing excellent connections to nearby towns such as Torrevieja and Cartagena.

### Modern Mediterranean Living – Bungalows with Garden or Solarium

This boutique development offers 2 and 3 bedroom bungalows with two distinct layouts:

Ground floor homes with private gardens

Top floor homes with spacious private solariums

Each property is designed to maximize comfort, natural light, and open spaces, ideal for both permanent living and holiday retreats. All homes include a private parking space and storage room, and enjoy access to a large communal swimming pool and a fully equipped gym.

As an optional upgrade, residents may add a private swimming pool, further enhancing the exclusivity and enjoyment of outdoor living.

### High-Quality Features and Customization Options

These new build bungalows are built to the highest standards, offering:

Aluminium windows with thermal break and electric shutters for comfort and energy efficiency

Underfloor heating in bathrooms for year-round warmth



# Floor plans

## PLANO PLANTA BAJA / GROUND FLOOR PLAN

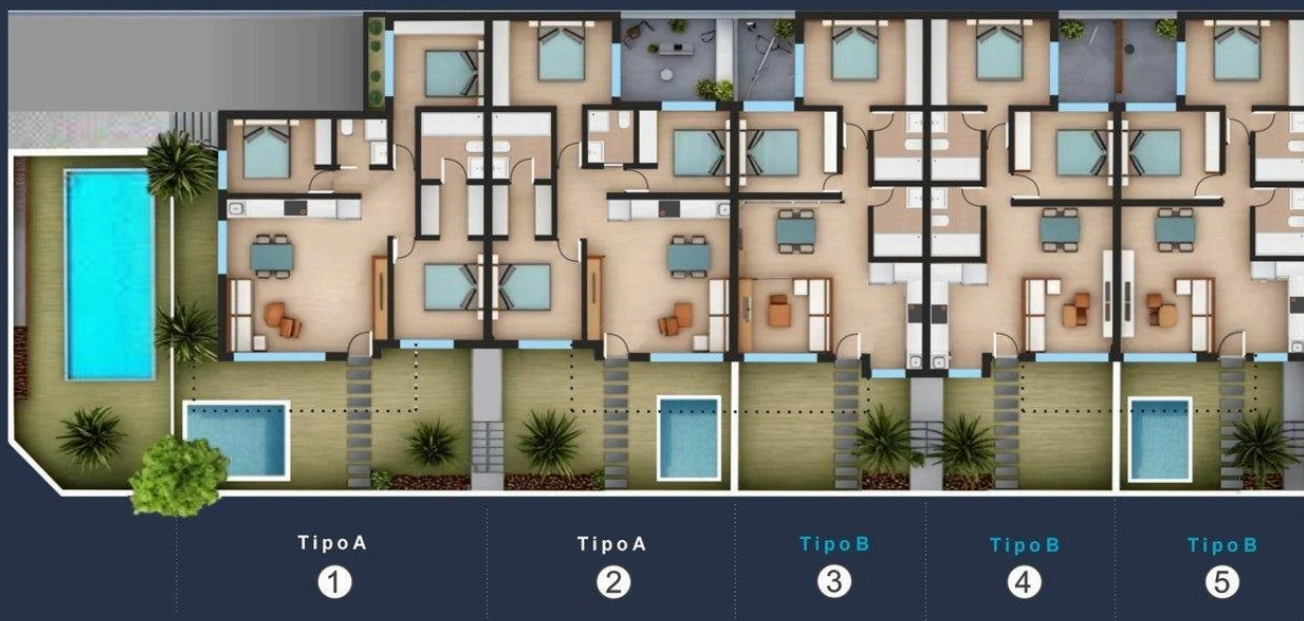

### Tipo B

- 2 Dormitorios
- 2 Baños
- Garaje
- Trastero

### Type B

- 2 Bedrooms
- 2 Bathrooms
- Garage
- Storage room

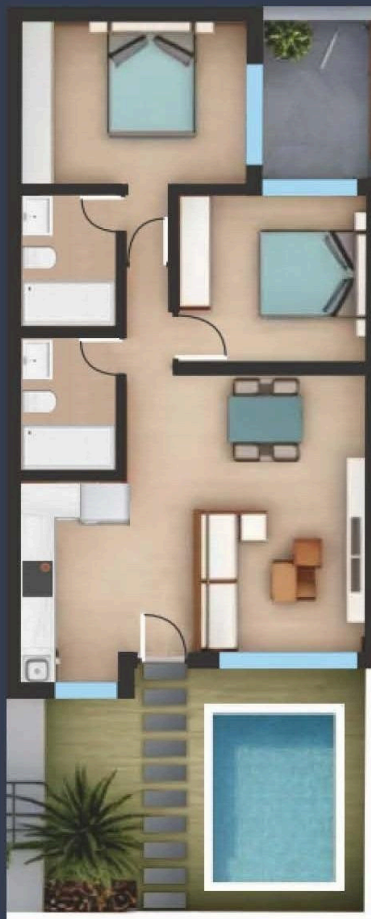

# Additional information

## Facilities

Aircondition, Provision	Gated complex	Gym
Parking, Uncovered	Pool, Private	

## Features

Garden	Near bus route
--------	----------------

## Distances

Sea
 2 km